



MATSON

Full Overlay

Matson Featured in Carmel Finish.

MAPLETON

Standard Overlay



Mapleton Featured in Wheat Finish.

Matson / Mapleton

In the hands of expert cabinetmakers, excellent craftsmanship, exceptional quality and superior value are all expressed in **Matson/Mapleton**. The subtle richness and texture of solid maple bathed in a tantalizing hue and sealed with a satin finish creates a warm inviting design in any kitchen. The warm, sophisticated look of **Matson/Mapleton** is sure to leave a lasting impression.

FEATURES

1. Base and wall cabinets feature concealed hanging rails for a clean interior appearance.
2. 1/2" thick medium density fiberboard four sided drawer box with standard dovetailed construction for durability.
3. Fully adjustable epoxy coated drawer guide system features lifetime warranty.
4. 1/2" thick medium density fiberboard shelving dovetailed into base end panels for strength.
5. Durable 3/8" thick particle board end panels with UV coated maple woodgrain or white finish (depending on style) enhance interior.
6. 3/8" thick particle board floors with UV coated maple woodgrain or white finish are dadoed into base and wall cabinet end panels.
7. Hardwood face frames feature durable pocket route and screw construction.
8. Internal toe kick strengthens construction and keeps underside of cabinet rodent proof.
9. Self closing, adjustable concealed hinges feature lifetime warranty.
10. Matson comes as a full overlay. Mapleton design is a standard overlay.

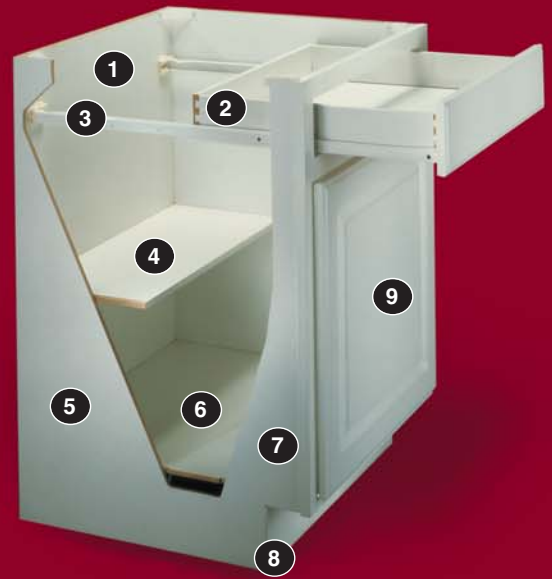

STYLES AVAILABLE

Matson Cathedral



Matson Square



Mapleton Cathedral



Mapleton Square



HINGE STYLE



CONCEALED HINGE



DOVETAIL CONSTRUCTION

Value By Design



www.sacoindustries.com